

# FAITH & FORM

THE INTERFAITH JOURNAL ON  
RELIGION, ART AND ARCHITECTURE  
VOL. XLIII • NO. 1, 2010 • ISSN 00147001



EDUCATION ISSUE  
Doing MORE With Less



# Doing **MORE** With Less

A portfolio of creative projects that get the most out of tight budgets and meager resources.

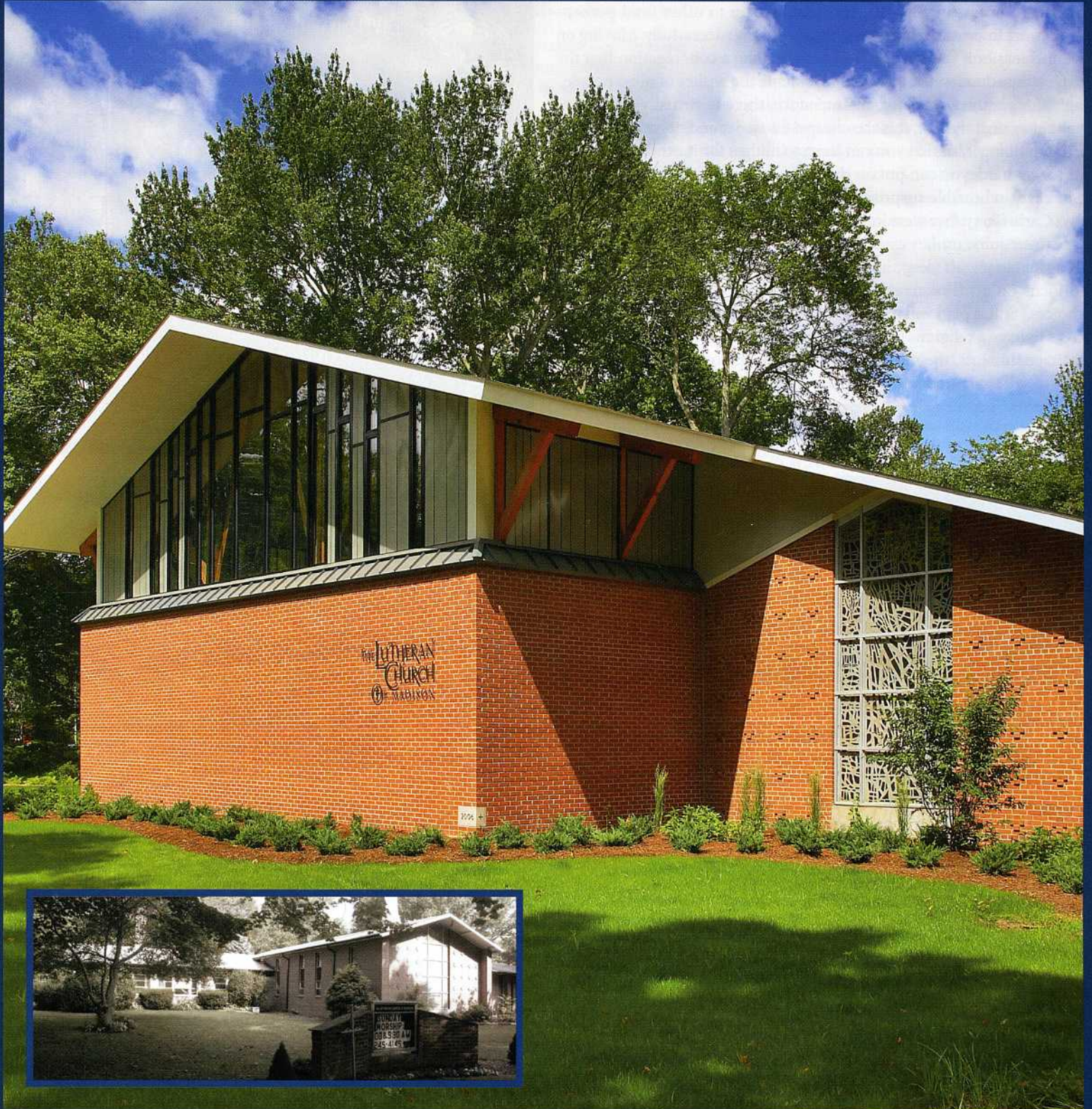

The new sanctuary was added onto the original sanctuary wing to the right, which is now a fellowship hall.  
Inset: The 1955-era building was virtually untouched for 50 years.

Photo: © Olson Photographic



# Lutheran Church of Madison

Madison, Connecticut › Duo Dickinson, Architect



*The new sanctuary glows from within, expressing the timber structural frame, visible through clear and translucent glass.*

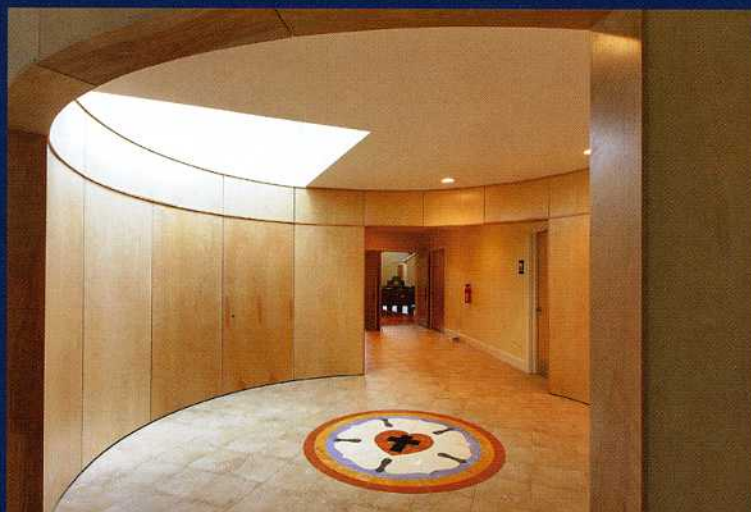

*Round narthex acts as an orientation device and delivers visitors to the new sanctuary beyond.*



*The new sanctuary as viewed from the balcony, displays its expressive timber frame and abundance of natural light.*

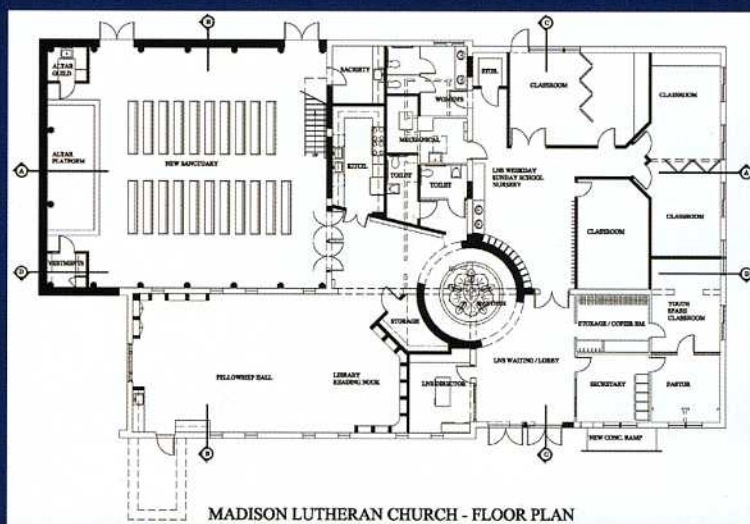

*Original plan elements are shown with white walls, while addition walls are shown in black. A new round narthex was created as the hub of the plan.*

The Lutheran Church of Madison, Connecticut, founded in 1949, built a sanctuary in 1955. In 2001 the church was thrilled to receive a building lot in nearby Killingworth. They assumed they could build a new building with pledged gifts and the proceeds from the sale of their existing building. When bid, the actual costs of building their new design outstripped any possible funding they could raise.

The congregation moved forward by taking a fresh look at their existing building, this time thinking budget first. Duo Dickinson, Architect, who regularly contributes pro bono work through his

practice, designed options that accommodated the funds that were available, approximately \$1.2 million. Edward Stanley Engineers contributed all but the timber frame's structural design services, while the project's builder, Waverly Construction, partnered with Bensonwood Timber Frame, which provided "left over" Douglas Fir timbers to great advantage at lower-than-retail cost in the sanctuary.

As Dickinson describes the approach: "We put the institution in the driver's seat with aggressive bidding and open-book costing-out of all options to allow for a direct connection between value and cost." The 8,000 square feet of new

and renovated space (a 3,000-square-foot new sanctuary and choir loft, and 5,000 square feet of gutted and rehabbed space: bathrooms, kitchen, sacristy, all nonbearing interior walls and surfaces) plus a revamped parking lot, new septic system, and entry recycled every bit of the existing building. The built result allows the church to accommodate full family programming, requiring one central entry for education, worship, and parish hall functions. To preserve a sense of the sacred despite this common entry, an internal "narthex" rotunda was created at the joint between parish hall, kitchen, worship space, and the common lobby.